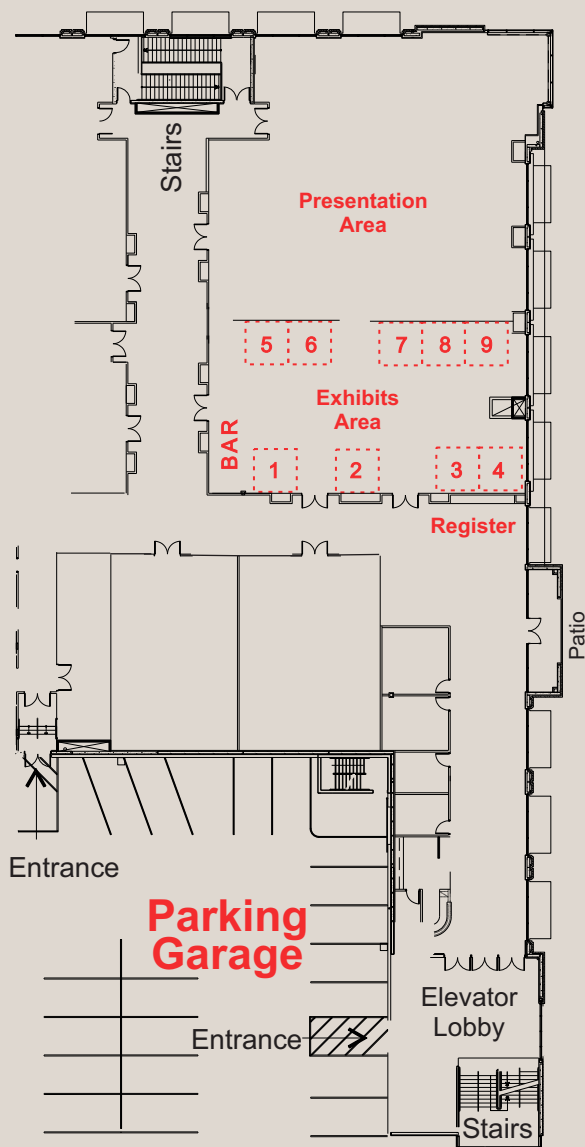

Exhibit Area



Geophysical Society of Houston
 14811 St. Mary's Lane #204
 Houston, Texas 77079
 281-741-1624 office@gshstx.org
 www.gshstx.org

Dave Hale

Dave Hale received a B.S. in physics from Texas A&M University in 1977 and a Ph.D. in geophysics from Stanford University in 1983. At Stanford, he studied with the Stanford Exploration Project.

He has worked as a field seismologist and research geophysicist for Western Geophysical, as a senior research geophysicist for Chevron, as an associate professor at the Colorado School of Mines, as a chief geophysicist and software developer for Advance Geophysical, and as a senior research fellow for Landmark Graphics. In 2005 he returned to Mines as the C.H. Green Professor of Exploration Geophysics, where he worked with the Center for Wave Phenomena until retiring in 2015. Dave now writes computer software with Dean Witte.

Dave received the Virgil Kauffman Gold Medal from the Society of Exploration Geophysicists for his work on dip-moveout processing of seismic data. He also received the SEG's awards for Best Paper in Geophysics in 1992 (imaging salt with seismic turning waves) and Best Paper Presented at the Annual Meeting in 2002 (atomic meshing of seismic images). In 2014 he gave the SEG's Distinguished Lecture (3D seismic image processing for interpretation of faults and horizons) to audiences worldwide. Dave taught the SEG's first course in dip-moveout processing as part of the Continuing Education program, and was editor of "DMO Processing", volume 16 of the Geophysics reprint series. Dave was made a Honorary member of the GSH in 2015.

Toast and Roast Messages in the Proceedings

Add your own personal message to Dave for posterity.

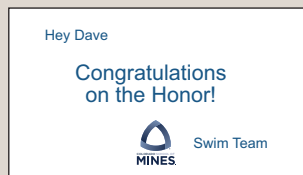

	B/W	Color
Business Card	\$50	\$80
Eighth Page	\$200	
Quarter Page	\$350	
Half Page	\$650	\$1,200
Full Page	\$1,000	\$2,000



GSH-SEG
 2018
 Spring Symposium



Sharper Imaging:
 Case studies highlighting
 advances in seismic acquisition
 and processing that impact drilling
 decisions on & offshore

Honoring
 Dave Hale



April 4-5, 2018
 Norris Conference Center
 Houston City Centre

Information Packet for
 Sponsors, Advertisers, and
 Exhibitors

The Geophysical Society of Houston and the Society of Exploration Geophysicists are pleased to announce their jointly sponsored 2018 Spring Symposium to be held in Houston, Texas on April 4-5. This annual event attracts approximately 300 geoscientists who enjoy two days of technical papers and discussion sessions, and honors an individual or individuals for their lifetime achievement in geophysics. This year's honoree is Dave Hale

Geophysical Society of Houston
 14811 St. Mary's Lane #204
 Houston, Texas 77079
 281-741-1624 office@gshstx.org
 www.gshstx.org

2018 GSH-SEG Spring Symposium

Sponsorships

The event is funded by a nominal registration fee plus sponsorships and advertising by industry corporations.

Sponsorships will be used to offset expenses of the event. Remaining funds, if any, will be divided among scholarship funds and other GSH technical, outreach and educational activities. Recognition of sponsorship, according to the donation level, will be displayed on the cover of the Proceedings Workbook, signage at the event, and posting on the SEG website and the GSH website plus publication in the *GSH Journal*. Complimentary registrations are included. The GSH is a 501(c)3 not for profit organization. Sponsorships are fully tax deductible.

Contact Information

Please send sponsorships and advertisements to: Karen Blakeman, Geophysical Society of Houston, 14811 Saint Mary's Lane, Suite 204, Houston, TX 77079, karen@gshsx.org, 281-741-1624. Make checks payable to The Geophysical Society of Houston and earmarked "2017 Spring Symposium."

Contact the GSH office for questions or additional information or visit the gshsx.org website and select "Activities and Events"

Geophysical Society of Houston
14811 St. Mary's Lane #204
Houston, Texas 77079
281-741-1624 office@gshsx.org
www.gshsx.org

2018 GSH-SEG Spring Symposium

Sponsorships Benefits

Sponsorship Levels

Event	\$20,000
Emerald	\$10,000
Ruby	\$5,000
Diamond	\$2,000
Sapphire	\$1,000
Citrine	\$500
Amethyst	\$250
Challenge Bowl	\$5,000
Speaker Gift Sponsor	\$2,000

Sponsor's company logo displayed on the following media.
The logo size will be scaled relative to the sponsorship level.

On the SEG Website
Sponsor posters displayed at the event
Rolling PowerPoint presentation shown during the event
In the event proceedings/abstracts booklet
On the GSH Website on the event webpage
On the GSH PowerPoint presentation show at GSH Events
On the GSH website homepage (\$5,000 and greater)
In the GSH Journal

Display of a sponsor provided poster
Event, Ruby and Emerald sponsors

Advertisement in the event proceedings/abstracts booklet

Event	Full Page Color plus logo displayed on the cover
Emerald	Full Page Color
Ruby	Full Page B/W
Diamond	Half Page B/W
Sapphire	Quarter Page B/W
Challenge Bowl	Full Page B/W
Speaker Gifts	Half Page B/W

Complimentary registrations

10 Registrations for the Event sponsor
5 for Emerald
3 for Ruby
1 for Diamond
2 for Challenge Bowl
1 for Speaker Gifts

Geophysical Society of Houston
14811 St. Mary's Lane #204
Houston, Texas 77079
281-741-1624 office@gshsx.org
www.gshsx.org

2018 GSH-SEG Spring Symposium

Proceedings Booklet Advertising Rates

Advertisement space is available in the event proceedings booklets at the following rates:

Full Page Color	\$2,000
Half Page Color	\$1,200
Full Page B/W	\$1,000
Half Page B/W	\$650

Rotating PowerPoint at Event

Slide with user content in rotating presentation at event and continuously in the exhibit space \$200

Exhibit Booths

Exhibitor booths cost \$2,000 each for the 2 days of the event.

Each booth is 10' wide x 10' deep.

Included are:
Logo displayed on the GSH Website on the event webpage
2 complimentary registrations
Carpet is in the room
Table, 2 chairs
Wifi
Power outlet strip
Logo on rotating PowerPoint

Special Dedicated Vendor Hour break during the middle of the presentations

Contact Karen Blakeman Karen@gshsx.org (281-741-1624) for more details or to sign up for a booth.

Geophysical Society of Houston
14811 St. Mary's Lane #204
Houston, Texas 77079
281-741-1624 office@gshsx.org
www.gshsx.org